



2021 35' COACHMEN MIRADA BH



FEATURES

- 15,000 BTU AC/HEAT Front
- 15,000 BTU AC/HEAT Back
- 30,000 BTU Furnace
- LED TVs inside / outside
- Theater Seats with Massage
- Lots of storage space inside and outside
- 12v, 110v, and USB outlets
- 1000 Watt Inverter with two
- 6-volt batteries
- Auto Generator Start
- Radio & Bluetooth Speakers
- Awning
- Fireplace
- Kingsize Bed
- Double Slide Out
- Premium Seating
- Luxury Kitchen
- Luxury Restroom

DIMENSIONS

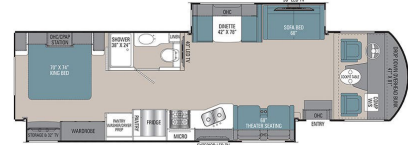

- Length 32.92 ft.
- Width 8.46 ft.
- Height 12.17 ft.
- GVWR: 18000

AMENITIES

- ⚡ 30' 50 AMP Powercord
- 🔌 55-AMP 110/12-volt power converter
- ⚡ 250V
- 💧 70 Gallon Fresh Water / 45 Black/Grey Tank
- 🔥 6 Gallon (Gas/Electric) D.S.I Water Heater
- 🔊 5.5 Onan Generator Onboard

NEED FOR RENTAL

- 👤 Driver must have a valid driver's license
- "Winter Package" Inquire within to learn more.

STAGE
12

CALL US TODAY
763.670.4191
978.514.4348

STAGE
14



hello@wheelsuprentals.com



www.wheelsuprentals.com